

NOTICE!!

These documents have been scanned!

Do not place un-scanned documents beneath this notice!

Do not remove this notice from this file!

GPO Jacket No. 560-102
Print Order 61540
Rise Business Services, LLC
Job=AZ15 4/26/2019



Box Number= AZ15001



Claim Begin-End: AMC451026-AMC451031

1 Initial Receipt



AZ15001-22

AMC450400-AMC453366

United States Department of the Interior
Bureau of Land Management
 DIV OF LANDS, MINRLS & ENERGY
 ONE N CENTRAL AVE
 PHOENIX, AZ 85004 -4427
 Phone: 602-417-9200

Receipt

No: 4178577

Transaction #: 4293077	
Date of Transaction: 06/01/2018	
CUSTOMER:	
	PERSHING RESOURCES 200 S VIRGINIA ST FL 8 RENO,NV 89501-2403 US

ENTERED
 JUN 11 2018
 BY: *RAM*

LINE #	QTY	DESCRIPTION	REMARKS	UNIT PRICE	TOTAL
1	6.00	LOCATABLE MINERALS / MINING CLAIMS-NEW,UNADJUD, ONE OR MORE AUTH NOS / NEW MINING CLAIM PROCESSING FEE CASES: AMC451026/\$20.00, AMC451027/\$20.00, AMC451028/\$20.00, AMC451029/\$20.00, AMC451030/\$20.00, AMC451031/\$20.00		- n/a -	120.00
2	6.00	LOCATABLE MINERALS / MINING CLAIMS-NEW,UNADJUD, ONE OR MORE AUTH NOS / NEW MINING CLAIMS LOCATION FEE CASES: AMC451026/\$37.00, AMC451027/\$37.00, AMC451028/\$37.00, AMC451029/\$37.00, AMC451030/\$37.00, AMC451031/\$37.00		- n/a -	222.00
3	6.00	LOCATABLE MINERALS / MINING CLAIMS-NEW,UNADJUD, ONE OR MORE AUTH NOS / NEW MINING CLAIMS MAINTENANCE FEE CASES: AMC451026/\$155.00, AMC451027/\$155.00, AMC451028/\$155.00, AMC451029/\$155.00, AMC451030/\$155.00, AMC451031/\$155.00		- n/a -	930.00
TOTAL:					\$1,272.00

PAYMENT INFORMATION				
1	AMOUNT:	1272.00	POSTMARKED:	N/A
	TYPE:	CHECK	RECEIVED:	06/01/2018
	CHECK NO:	6786102531		
	NAME:	200 S VIRGINIA ST FL 8 RENO NV 89501-2403 US		

NOTICE!!

These documents have been scanned!

Do not place un-scanned documents beneath this notice!

Do not remove this notice from this file!

GPO Jacket No. 560-102
Print Order 61540
Rise Business Services, LLC
Job=AZ15 4/26/2019



Box Number= AZ15001



Claim Begin-End: AMC451026-AMC451031

2 Correspondence



AZ15001-22

AMC450400-AMC453366

**NO
DOCUMENTS
FOUND**

NO DOCUMENTS FOUND
NO DOCUMENTS FOUND

NOTICE!!

These documents have been scanned!

Do not place un-scanned documents beneath this notice!

Do not remove this notice from this file!

GPO Jacket No. 560-102
Print Order 61540
Rise Business Services, LLC
Job=AZ15 4/26/2019



Box Number= AZ15001



Claim Begin-End: AMC451026-AMC451031

3 Transfers



AZ15001-22

AMC450400-AMC453366

**NO
DOCUMENTS
FOUND**

NO DOCUMENTS FOUND
NO DOCUMENTS FOUND

NOTICE!!

These documents have been scanned!

Do not place un-scanned documents beneath this notice!

Do not remove this notice from this file!

GPO Jacket No. 560-102
Print Order 61540
Rise Business Services, LLC
Job=AZ15 4/26/2019



Box Number= AZ15001



Claim Begin-End: AMC451026-AMC451031

4 Annual Filings



AZ15001-22

AMC450400-AMC453366

DEPARTMENT OF THE INTERIOR
BUREAU OF LAND MANAGEMENT
MINING CLAIMS

Run Date/Time: 8/20/2018

MC Maintenance Fees Paid Through the BLM Pay Portal
(by Date Paid)

Page 255 Of 316

CBS Receipt: 4237278

Printed For Lead File # AMC451026

Agency Tracking ID: 1534423521

Assessment Year: 2019

Number of BLM Serial Nr: 10

Paid On: 8/16/2018

Total Amount Paid: \$1,550.00

Claim Name	BLM Serial No	Lead File No	Amount Paid
EN 89	AMC451004	AMC450979	\$155.00
EN 90	AMC451005	AMC450979	\$155.00
EN 91	AMC451006	AMC450979	\$155.00
EN 139	AMC451026	AMC451026	\$155.00
EN 141	AMC451027	AMC451026	\$155.00
EN 143	AMC451028	AMC451026	\$155.00
EN 145	AMC451029	AMC451026	\$155.00
EN 147	AMC451030	AMC451026	\$155.00
EN 149	AMC451031	AMC451026	\$155.00
EN 97	AMC451342	AMC451342	\$155.00

United States Department of the Interior

Bureau of Land Management
 BUSINESS & SUPPORT SVCS DIV
 ONE N CENTRAL AVE SUITE 800
 PHOENIX, AZ 85004 -4427
 Phone: 602-417-9200

Receipt

No: 4237278

Transaction #: 4352660	
Date of Transaction: 08/16/2018	
CUSTOMER:	
JOEL ADAMS 145 WEST 67TH NEW YORK, NY 10023 US	

LINE #	QTY	DESCRIPTION	REMARKS	UNIT PRICE	TOTAL
1	1.00	LOCATABLE MINERALS / MINING CLAIMS- NOT NEW-UNADJUD, ONE AUTH NO. ONLY / MINING CLAIM MONEY RECEIVED CASES: AMC451004/\$1550.00		- n/a -	1550.00
TOTAL:					\$1,550.00

PAYMENT INFORMATION			
NOTE: Items will appear on credit card statement as "BLM O Mining Claim".			
1	AMOUNT:	1550.00	POSTMARKED: N/A
	TYPE:	CREDIT CARD	RECEIVED: 08/16/2018
	NAME:	JOEL ADAMS 145 WEST 67TH NEW YORK NY 10023 US	
	CARD NO:	XXXXXXXXXXXX2270	AUTH CODE: 033645
	NAME ON CARD:	JOEL ADAMS	
	SIGNATURE:		

REMARKS

This receipt was generated by the automated BLM Collections and Billing System and is a paper representation of a portion of the official electronic record contained therein.

NOTICE!!

These documents have been scanned!

Do not place un-scanned documents beneath this notice!

Do not remove this notice from this file!

GPO Jacket No. 560-102
Print Order 61540
Rise Business Services, LLC
Job=AZ15 4/26/2019



Box Number= AZ15001



Claim Begin-End: AMC451026-AMC451031

5 Miscellaneous



AZ15001-22 AMC450400-AMC453366

**NO
DOCUMENTS
FOUND**

NO DOCUMENTS FOUND
NO DOCUMENTS FOUND

NOTICE!!

These documents have been scanned!

Do not place un-scanned documents beneath this notice!

Do not remove this notice from this file!

GPO Jacket No. 560-102
Print Order 61540
Rise Business Services, LLC
Job=AZ15 4/26/2019



Box Number= AZ15001



Claim Begin-End: AMC451026-AMC451031

6 Location Notices-Amendments and Supporting Documents



AZ15001-22 AMC450400-AMC453366

NING CLAIM STATUS REPORT

Data Entered: 6/11/18 RAM

MTP Checked By: 6/11/18 RAM
GEO Checked By: 6/11/18 RAM

LEAD SERIAL NUMBER: AMC 451026 thru AMC 451031

NUMBER OF CLAIMS & TYPE:

6 LODE
PLACER
ASSOCIATION PLACER
MILL SITE
TUNNEL SITE

CHARGES:

Processing Fee @ \$20 = \$ 120
Location Fee @ \$37 = \$ 222
Maintenance Fee @ \$155 = \$ 930
Add'l Maint Fee for Assoc Placer = \$
SUBTOTAL \$ 1272
Other Fees \$
Other Fees \$
TOTAL \$

TOTAL ACREAGE: Per Claim
(Placer Only)

NUMBER OF LOCATORS:

DOCUMENTS RECEIVED VIA: Over-the-Counter [] Mail [X] TIMELY FILED: Yes [X] No []

LEGAL DESCRIPTION: T 20N R 15W SEC 11, 12
T R SEC
T R SEC
T R SEC
T R SEC

BLM [] FOREST SERVICE [] SUBJ TO PL 359: Yes [] No []
WILDERNESS AREA []

SPLIT ESTATE: N/A [] SX [] PX [] OTHER []
SRHA [] Was proper Notice filed if located on SHRA Land? Yes [] No []

RECONVEYED MINERALS ON BLM LAND REQUIRE OPENING ORDER FROM 1944 TO 1993:

Open to Entry On sec 12 on 11/2/1987 N/A []

COMMENTS/STATUS: VOID [] PARTIALLY VOID [] PVT MINERALS [] WITHDRAWN LANDS []
OTHER []

PERSHING RESOURCES CO has agent, NICK BARR, locating the claims.

[] Claimant acknowledges that portions of the following claim(s) site(s) may be void or voidable.

Printed Name of Claimant Signature of Claimant

*****FINAL ADJUDICATION*****

DATE 8/8/18 INITIALS PB

2

FEE# 2018019630

OFFICIAL RECORDS OF MOHAVE COUNTY KRISTI BLAIR, COUNTY RECORDER



04/19/2018 03:36 PM Fee: \$10.00

PAGE: 1 of 2

After recording return to: Pershing Resources 200 S. Virginia St. 8th Floor Reno, Nevada 89501

LOCATION NOTICE FOR LODE MINING CLAIM

Amendment BLM Serial #

NOTICE IS HEREBY GIVEN that the

EN # 139 lode mining claim has been located by Nicholas BARR (agent) whose current mailing address is 5441 E. Mining Camp St. Apache Junction, AZ 85119

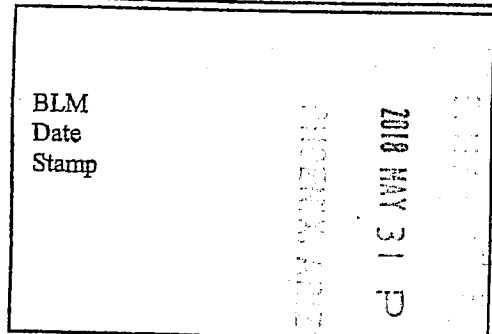

The general course of this claim is E-W and it is situated in Mohave County, Arizona. This claim is 1500 feet in length and 600 feet in width.

20 Total Claim Acreage. This claim runs from the location monument on which this location notice is posted on the centerline of the claim approximately 20 feet in a W direction to the W end line and 1480 feet in a E direction to the E end line. This claim is marked by six monuments, one at each corner and one at the center of each end line of the claim.

The location monument on which this notice is posted is situated within Section 11, Township 20 N, Range 15 W, Gila Salt River Base and Meridian, Arizona and this claim encompasses portions of the following quarter section(s), section(s), Township(s) and Range(s)

NE 1/4 Section 11 & NW 1/4 Section 12 T. 20 N, R. 15 W.

Gila Salt River Base and Meridian, Arizona.

The locality of this claim with reference to some natural object or permanent monument and additional information (if any) concerning its locality are as follows:

The NE CORNER of claim is located 4900 ft. WEST and 6650 ft. SOUTH of survey monument located at NE Corner Section 1, T. 20 N, R. 15 W. GSRB & M. The above information is shown on the attached map.

DATED AND POSTED on the ground this 25 day of March, 2018.

LOCATOR(s) AGENT

Print Name(s) Nicholas Barr

Signature(s) Nicholas Barr

(Agent for Pershing Resources) Form MCF100

AMC451026

MINING CLAIM MAP

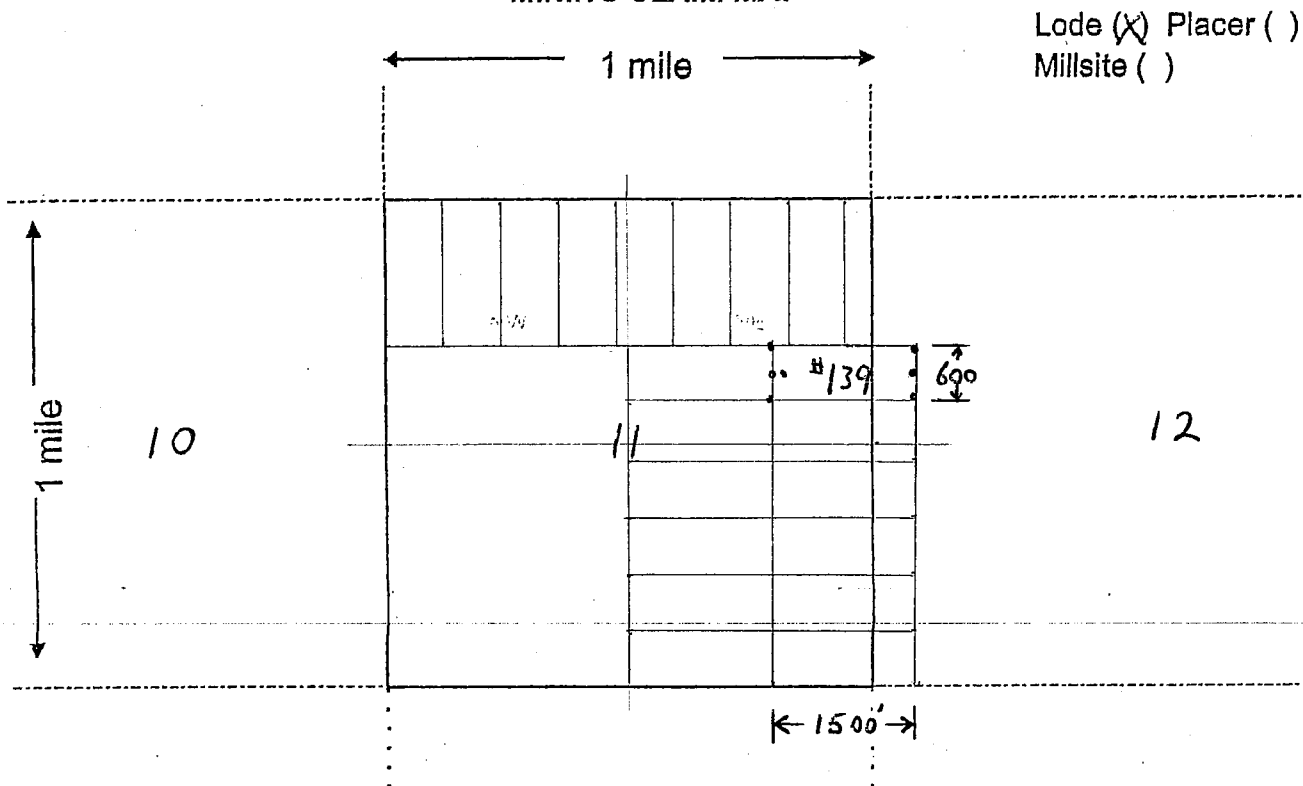

AMC451026

Scale: 1" = 2000 feet



1. The above map depicts the EN # 139 mining claim, which is located in Section (s) 11 & 12, Township 20 N, Range 15 W, Gila and Salt River Base and Meridian, Mohave County, Arizona. Total claim acreage is 20 acres

2. The type of corner and location monuments used are as follows: 2" x 2" x 4ft wood posts

3. The bearings and distances in degrees and feet between claim corners and to a public land survey monument are as depicted on the map.

4. If the claim is a placer or millsite claim with exterior limits conforming to legal subdivisions of the public survey, provide a legal description of the claim _____

Form MCF100a
Revised July 2014

FEE# 2018019632

OFFICIAL RECORDS OF MOHAVE COUNTY KRISTI BLAIR, COUNTY RECORDER



04/19/2018 03:36 PM Fee: \$10.00

PAGE: 1 of 2

After recording return to: Pershing Resources 200 S. Virginia St. 8th Floor Reno, Nevada 89501

LOCATION NOTICE FOR LODE MINING CLAIM

Amendment BLM Serial #

NOTICE IS HEREBY GIVEN that the EN# 141 lode mining claim has been located by Nicholas BARR (agent) whose current mailing address is 5441 E. Mining Camp St. Apache Junction, AZ 85119

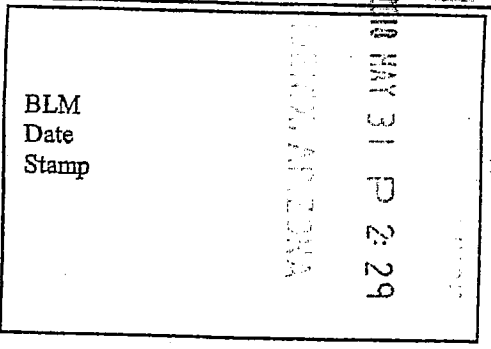

The general course of this claim is E-W and it is situated in Mohave County, Arizona. This claim is 1500 feet in length and 600 feet in width.

20 Total Claim Acreage. This claim runs from the location monument on which this location notice is posted on the centerline of the claim approximately 20 feet in a W direction to the W end line and 1480 feet in a E direction to the E end line. This claim is marked by six monuments, one at each corner and one at the center of each end line of the claim.

The location monument on which this notice is posted is situated within Section 11, Township 20 N, Range 15 W, Gila Salt River Base and Meridian, Arizona and this claim encompasses portions of the following quarter section(s), section(s), Township(s) and Range(s) NE & SE 1/4 Section 11 & NW & SW 1/4 Section 12 T. 20N, R. 15W. Gila Salt River Base and Meridian, Arizona.

The locality of this claim with reference to some natural object or permanent monument and additional information (if any) concerning its locality are as follows: The NE CORNER of claim is located 4900 ft. WEST and 7250 ft. SOUTH of survey monument located at NE Corner Section 1, T. 20N, R. 15W, GSRB&M. The above information is shown on the attached map.

DATED AND POSTED on the ground this 25 day of March, 2018.

LOCATOR(s) AGENT

Print Name(s) Nicholas Barr

Signature(s) Nicholas Barr

(Agent for Pershing Resources) Form MCF100

ANCH51027

MINING CLAIM MAP

Lode (X) Placer ()
Millsite ()

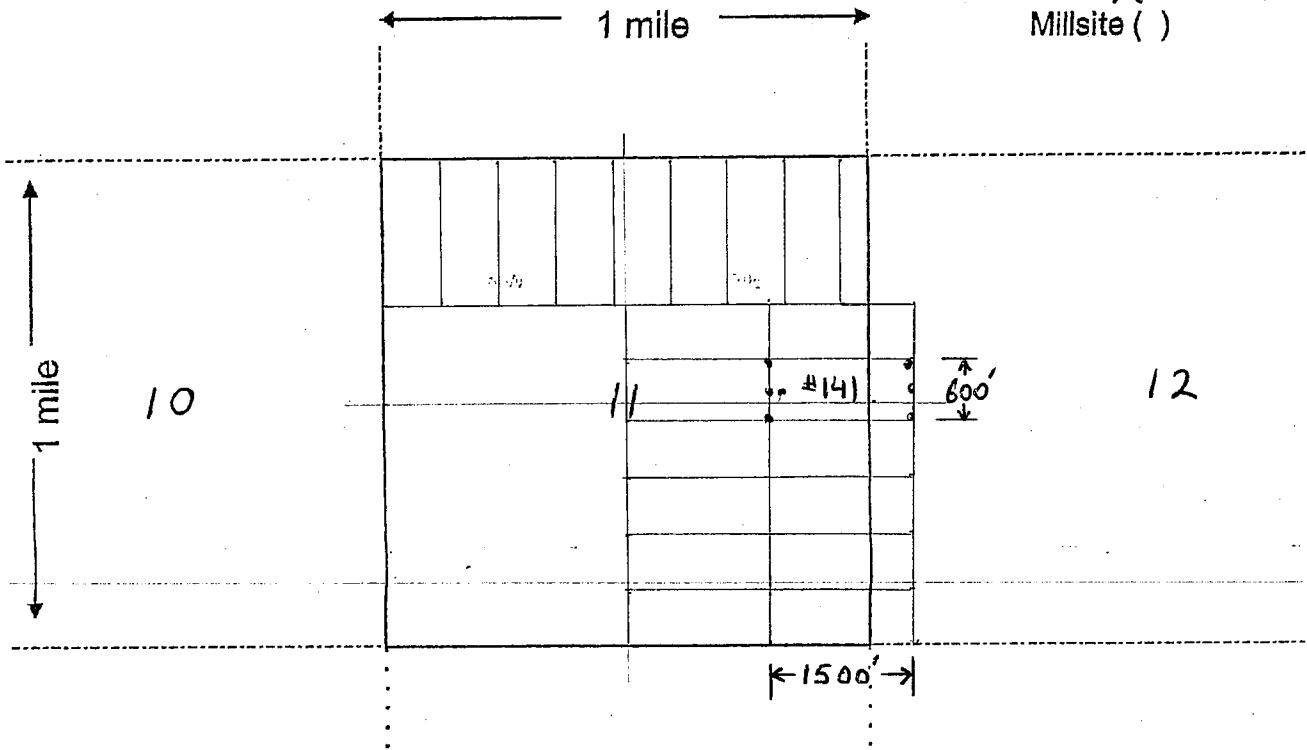

Scale: 1" = 2000 feet



AMC451027

1. The above map depicts the EN # 141 mining claim, which is located in Section (s) 11, 12, Township 20 N, Range 15 W, Gila and Salt River Base and Meridian, Mohave County, Arizona. Total claim acreage is 20 acres

2. The type of corner and location monuments used are as follows: 2" x 2" x 4 ft wood posts

3. The bearings and distances in degrees and feet between claim corners and to a public land survey monument are as depicted on the map.

4. If the claim is a placer or millsite claim with exterior limits conforming to legal subdivisions of the public survey, provide a legal description of the claim _____

Form MCF100a
Revised July 2014

2

After recording return to:
Pershing Resources
200 S. Virginia St. 8th Floor
Reno, Nevada 89501

FEE# 2018019634

OFFICIAL RECORDS
OF MOHAVE COUNTY
KRISTI BLAIR,
COUNTY RECORDER



04/19/2018 03:36 PM Fee: \$10.00

PAGE: 1 of 2

LOCATION NOTICE FOR LODE MINING CLAIM

Amendment BLM Serial # _____

NOTICE IS HEREBY GIVEN that the _____

EN # 143 lode mining claim has been located
by Nicholas BARR (agent) whose current mailing
address is 5441 E. Mining Camp St.
Apache Junction, AZ 85119

BLM
Date
Stamp
2018 MAY 31 P 2:29

The general course of this claim is E-W and it is situated in Mohave
County, Arizona. This claim is 1500 feet in length and 600 feet in width.

20 Total Claim Acreage. This claim runs from the location monument on which this location notice
is posted on the centerline of the claim approximately 20 feet in a W direction to the W
end line and 1480 feet in a E direction to the E end line. This claim is marked by six
monuments, one at each corner and one at the center of each end line of the claim.

The location monument on which this notice is posted is situated within Section 11, Township 20
N, Range 15 W, Gila Salt River Base and Meridian, Arizona and this claim encompasses portions
of the following quarter section(s), section(s), Township(s) and Range(s) _____

SE 1/4 Section 11 & SW 1/4 Section 12 T. 20 N, R. 15 W.
Gila Salt River Base and Meridian, Arizona.

The locality of this claim with reference to some natural object or permanent monument and additional information
(if any) concerning its locality are as follows: The NE CORNER of claim is located
4900 ft WEST and 7850 ft SOUTH of survey monument located at
NE Corner Section 1, T. 20 N, R. 15 W, GSRBEM
The above information is shown on the attached map.

DATED AND POSTED on the ground this 25 day of March, 2018.

LOCATOR(s) AGENT

Print Name(s) Nicholas Barr

Signature(s) Nicholas Barr

(Agent for Pershing Resources) Form MCF100

ANC451028

MINING CLAIM MAP

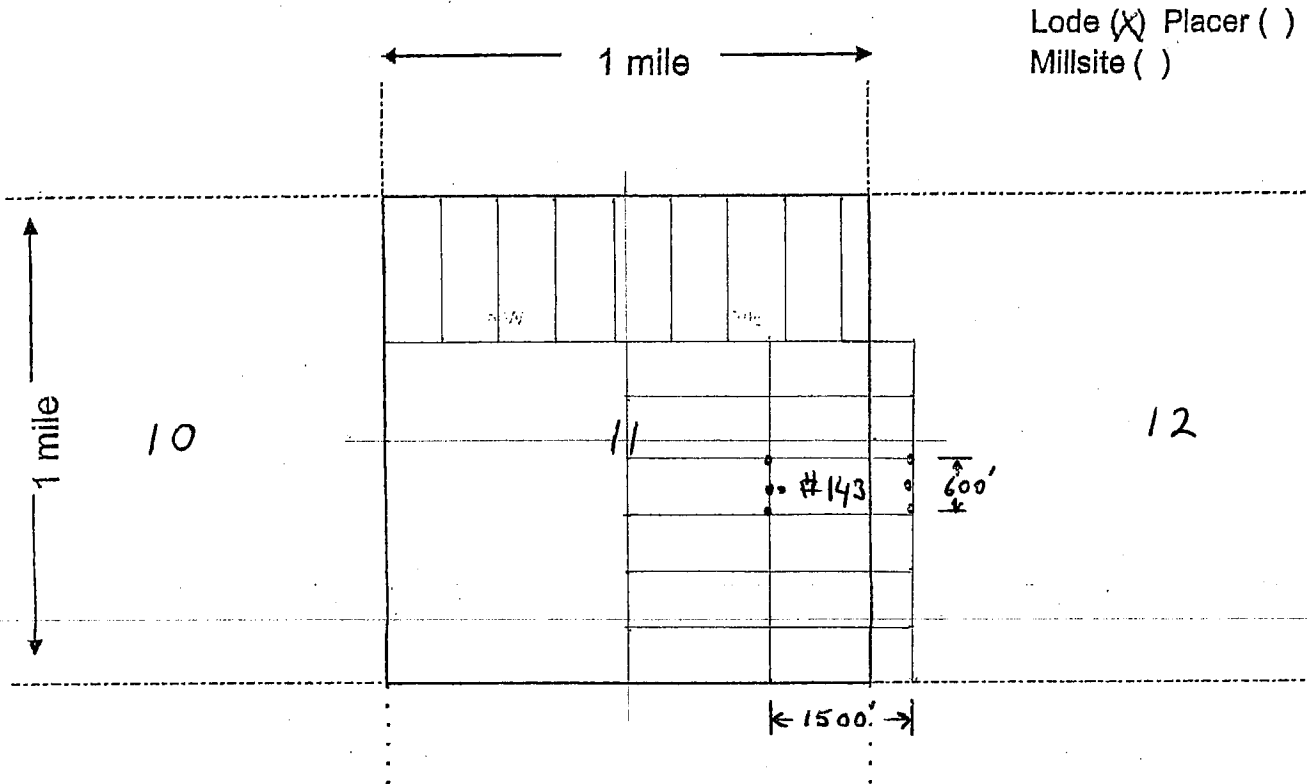

AMC451028

Scale: 1" = 2000 feet



1. The above map depicts the EN # 143 mining claim, which is located in Section (s) 1112, Township 20 N, Range 15 W, Gila and Salt River Base and Meridian, Mohave County, Arizona. Total claim acreage is 20 acres

2. The type of corner and location monuments used are as follows: 2" x 2" x 4ft wood posts

3. The bearings and distances in degrees and feet between claim corners and to a public land survey monument are as depicted on the map.

4. If the claim is a placer or millsite claim with exterior limits conforming to legal subdivisions of the public survey, provide a legal description of the claim _____

Form MCF100a
Revised July 2014

This form is available from the Arizona Geology Survey and may be reproduced.

2

After recording return to:
Pershing Resources
200 S. Virginia St. 8th Floor
Reno, Nevada 89501

FEE# 2018019636

OFFICIAL RECORDS
OF MOHAVE COUNTY
KRISTI BLAIR,
COUNTY RECORDER



04/19/2018 03:36 PM Fee: \$10.00

PAGE: 1 of 2

LOCATION NOTICE FOR LODE MINING CLAIM

Amendment BLM Serial# _____

NOTICE IS HEREBY GIVEN that the _____

EN # 145 lode mining claim has been located
by Nicholas BARR (agent) whose current mailing
address is 5441 E. Mining Camp St.
Apache Junction, AZ 85119

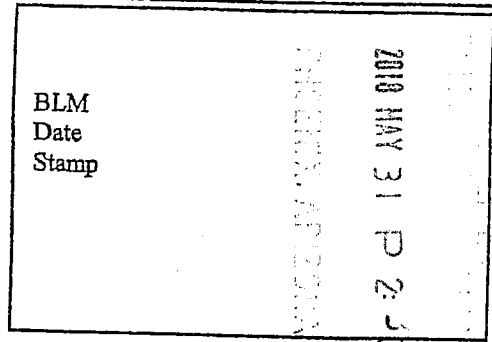

The general course of this claim is E-W and it is situated in Mohave
County, Arizona. This claim is 1500 feet in length and 600 feet in width.

20 Total Claim Acreage. This claim runs from the location monument on which this location notice
is posted on the centerline of the claim approximately 20 feet in a W direction to the W
end line and 1480 feet in a E direction to the E end line. This claim is marked by six
monuments, one at each corner and one at the center of each end line of the claim.

The location monument on which this notice is posted is situated within Section 11, Township 20
N, Range 15 W, Gila Salt River Base and Meridian, Arizona and this claim encompasses portions
of the following quarter section(s), section(s), Township(s) and Range(s) _____

SE 1/4 Section 11 & SW 1/4 Section 12 T. 20 N, R. 15 W.

Gila Salt River Base and Meridian, Arizona.

The locality of this claim with reference to some natural object or permanent monument and additional information
(if any) concerning its locality are as follows: The NE CORNER of claim is located
4900 ft. WEST and 8450⁰⁰ ft. SOUTH of survey monument located at
NE Corner Section 1, T. 20 N, R. 15 W. GSRB & M The above information is shown on the attached map.

DATED AND POSTED on the ground this 25 day of March, 2018.

LOCATOR(s) AGENT

Print Name(s) Nicholas Barr

Signature(s) Nicholas Barr

(Agent for Pershing Resources) Form MCF100

AN0451029

MINING CLAIM MAP

Lode (X) Placer ()
Millsite ()

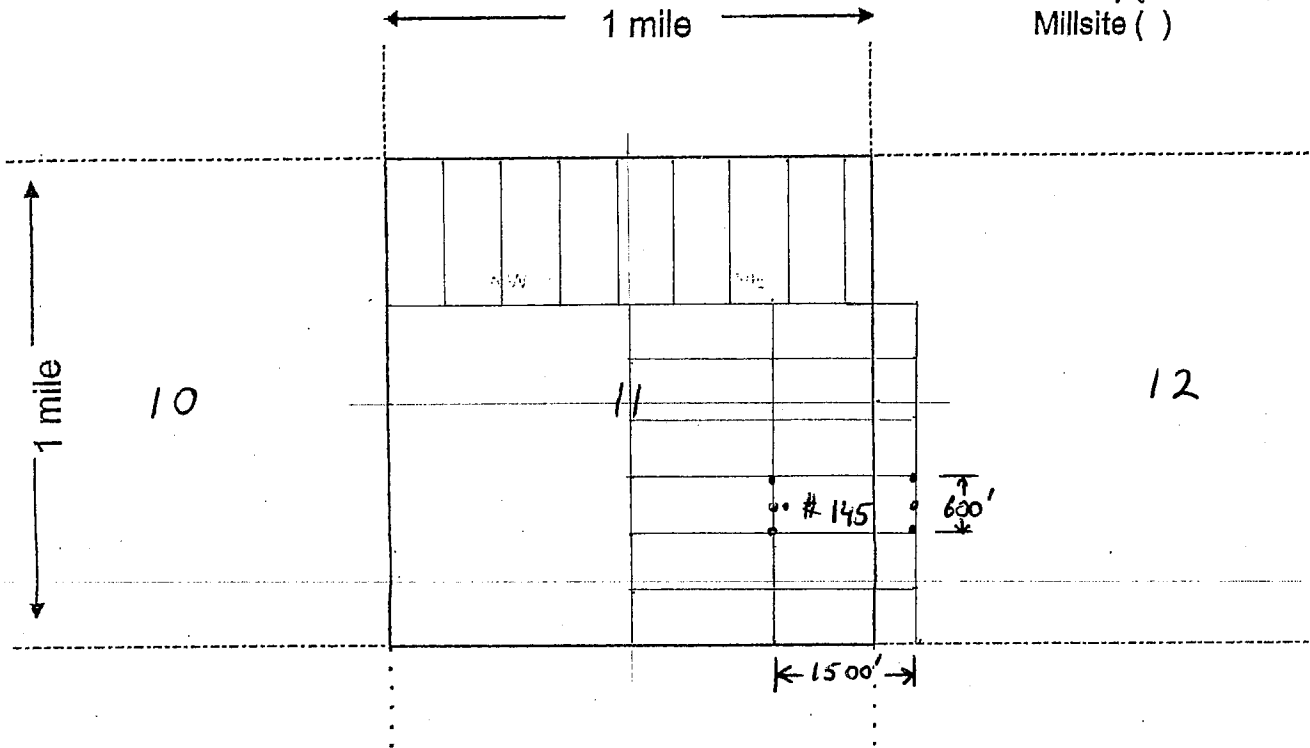

Scale: 1" = 2000 feet



ANCL 51029

1. The above map depicts the EN # 145 mining claim, which is located in Section (s) 11 & 12, Township 20 N, Range 15 W, Gila and Salt River Base and Meridian, Mohave County, Arizona. Total claim acreage is 20 acres

2. The type of corner and location monuments used are as follows: 2" x 2" x 4ft wood posts

3. The bearings and distances in degrees and feet between claim corners and to a public land survey monument are as depicted on the map.

4. If the claim is a placer or millsite claim with exterior limits conforming to legal subdivisions of the public survey, provide a legal description of the claim _____

Form MCF100a
Revised July 2014

FEE# 2018019638

OFFICIAL RECORDS OF MOHAVE COUNTY KRISTI BLAIR, COUNTY RECORDER



04/19/2018 03:36 PM Fee: \$10.00

PAGE: 1 of 2

After recording return to: Pershing Resources 200 S. Virginia St. 8th Floor Reno, Nevada 89501

LOCATION NOTICE FOR LODE MINING CLAIM

Amendment BLM Serial#

NOTICE IS HEREBY GIVEN that the

EN# 147 lode mining claim has been located

by Nicholas BARR (agent) whose current mailing address is 5441 E. Mining Camp St.

Apache Junction, AZ 85119

The general course of this claim is E-W and it is situated in Mohave County, Arizona. This claim is 1500 feet in length and 600 feet in width.

20 Total Claim Acreage. This claim runs from the location monument on which this location notice is posted on the centerline of the claim approximately 20 feet in a W direction to the W end line and 1480 feet in a E direction to the E end line. This claim is marked by six monuments, one at each corner and one at the center of each end line of the claim.

The location monument on which this notice is posted is situated within Section 11, Township 20 N, Range 15 W, Gila Salt River Base and Meridian, Arizona and this claim encompasses portions of the following quarter section(s), section(s), Township(s) and Range(s)

SE 1/4 Section 11 & SW 1/4 Section 12 T. 20 N, R. 15 W.

Gila Salt River Base and Meridian, Arizona.

The locality of this claim with reference to some natural object or permanent monument and additional information (if any) concerning its locality are as follows:

The NE CORNER of claim is located 4900 ft. WEST and 9050 ft. SOUTH of survey monument located at NE Corner Section 1, T. 20 N, R. 15 W, GSRB & M. The above information is shown on the attached map.

DATED AND POSTED on the ground this 25 day of March, 2018.

LOCATOR(s) AGENT

Print Name(s) Nicholas Barr

Signature(s) Nicholas Barr

(Agent for Pershing Resources) Form MCF100

BLM Date Stamp 2018 MAY 31 P. 2:30

AMC451030

MINING CLAIM MAP

Lode (X) Placer ()
Millsite ()

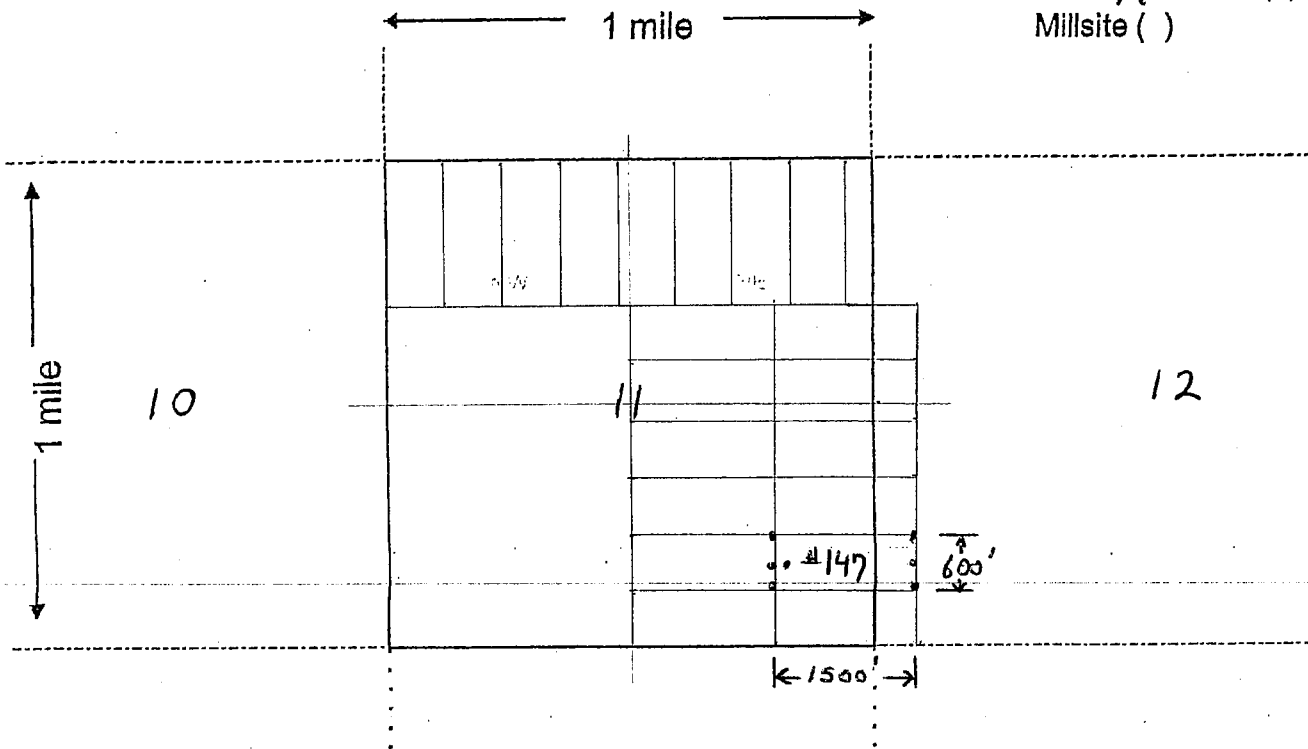

Scale: 1" = 2000 feet



1. The above map depicts the EN # 147 mining claim, which is located in Section (s) 11 & 12, Township 20 N, Range 15 W, Gila and Salt River Base and Meridian, Mohave County, Arizona. Total claim acreage is 20 acres

2. The type of corner and location monuments used are as follows: 2" x 2" x 4ft wood posts

3. The bearings and distances in degrees and feet between claim corners and to a public land survey monument are as depicted on the map.

4. If the claim is a placer or millsite claim with exterior limits conforming to legal subdivisions of the public survey, provide a legal description of the claim _____

Form MCF100a
Revised July 2014

This form is available from the Arizona Geology Survey and may be reproduced.

AMC451030

2

After recording return to:
Pershing Resources
200 S. Virginia St. 8th Floor
Reno, Nevada 89501

FEE# 2018019640

OFFICIAL RECORDS
OF MOHAVE COUNTY
KRISTI BLAIR,
COUNTY RECORDER



04/19/2018 03:36 PM Fee: \$10.00

PAGE: 1 of 2

LOCATION NOTICE FOR LODE MINING CLAIM

Amendment BLM Serial # _____

NOTICE IS HEREBY GIVEN that the
EN # 149 lode mining claim has been located
by Nicholas BARR (agent) whose current mailing
address is 5441 E. Mining Camp St.
Apache Junction, AZ 85119

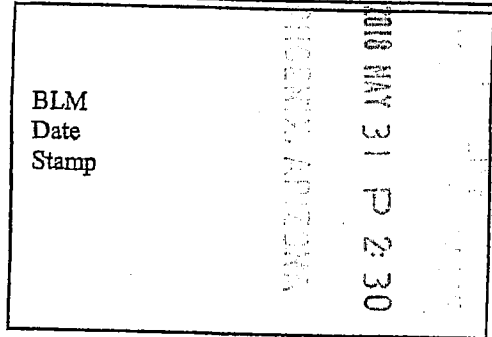

The general course of this claim is E-W and it is situated in Mohave
County, Arizona. This claim is 1500 feet in length and 600 feet in width.

20 Total Claim Acreage. This claim runs from the location monument on which this location notice
is posted on the centerline of the claim approximately 20 feet in a W direction to the W
end line and 1480 feet in a E direction to the E end line. This claim is marked by six
monuments, one at each corner and one at the center of each end line of the claim.

The location monument on which this notice is posted is situated within Section 11, Township 20
N, Range 15 W, Gila Salt River Base and Meridian, Arizona and this claim encompasses portions
of the following quarter section(s), section(s), Township(s) and Range(s)

SE 1/4 Section 11 & SW 1/4 Section 12 T. 20N, R. 15W.
Gila Salt River Base and Meridian, Arizona.

The locality of this claim with reference to some natural object or permanent monument and additional information
(if any) concerning its locality are as follows: The NE CORNER of claim is located
4900 ft. WEST and 9650 ft. SOUTH of survey monument located at
NE Corner Section 1, T. 20N, R. 15W, GSRB & M
The above information is shown on the attached map.

DATED AND POSTED on the ground this 25 day of March, 2018.

LOCATOR(s) AGENT

Print Name(s) Nicholas Barr

Signature(s) Nicholas Barr

(Agent for Pershing Resources) Form MCF100

AMC451031

MINING CLAIM MAP

Lode (X) Placer ()
Millsite ()

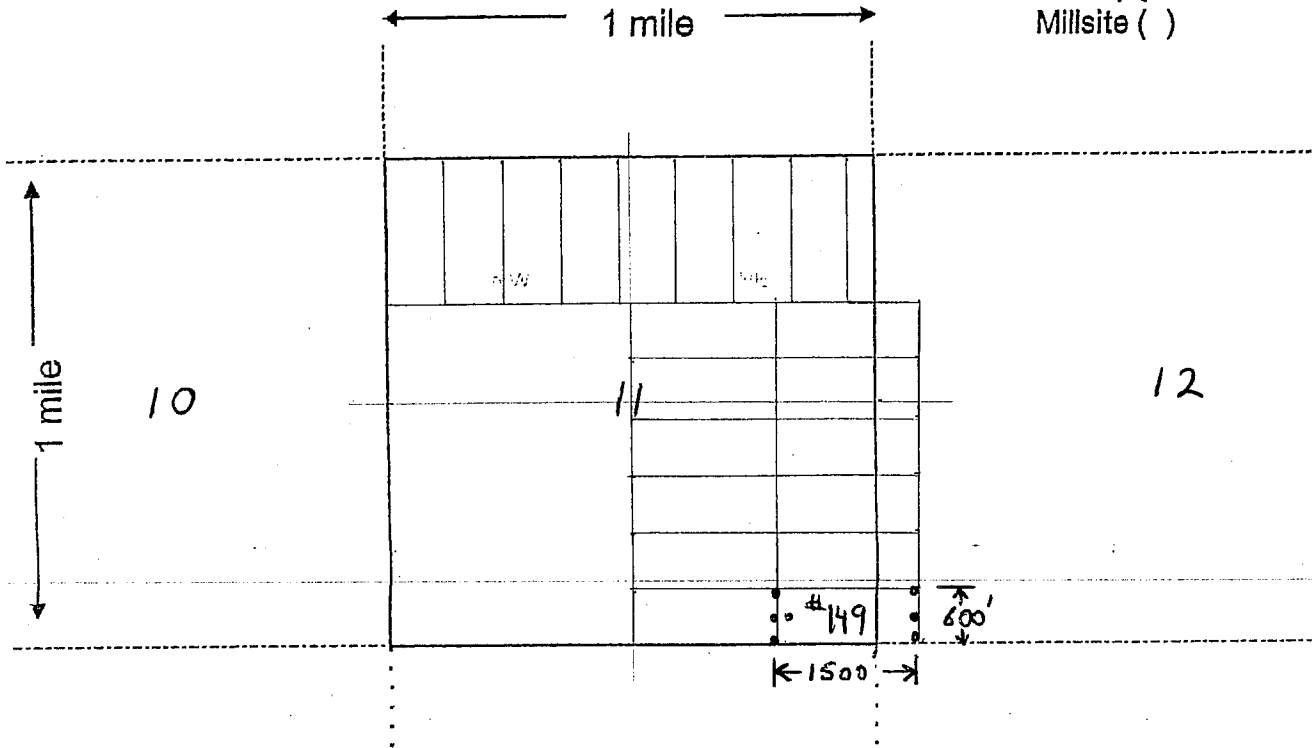

Scale: 1" = 2000 feet



1. The above map depicts the EN # 149 mining claim, which is located in Section (s) 11 & 12, Township 20 N, Range 15 W, Gila and Salt River Base and Meridian, Mohave County, Arizona. Total claim acreage is 20 acres

2. The type of corner and location monuments used are as follows: 2" x 2" x 4ft wood posts

3. The bearings and distances in degrees and feet between claim corners and to a public land survey monument are as depicted on the map.

4. If the claim is a placer or millsite claim with exterior limits conforming to legal subdivisions of the public survey, provide a legal description of the claim _____

Form MCF100a
Revised July 2014

This form is available from the Arizona Geology Survey and may be reproduced.

AMC451031

DEPARTMENT OF INTERIOR
BUREAU OF LAND MANAGEMENT

Input Parameters for Geographic Report with Land

System Id = CR

Admin State = AZ

Geo State =

Casetype Begins With

Case Disp Txt = AUTHORIZED, CANCELLED, EXPIRED, PENDING, REJECTED, VOID, WITHDRAWN

Mer Twp Rng =

Section =

Mtrs = 14 0200N 0150W 011, 14 0200N 0150W 012, 14 0200N 0150W 999

Commodity =

Commodity Txt =

Pending Org =

Pend Org Decode =

Total Rows Returned: 4

RUN TIME: 11:07 AM

UNITED STATES DEPARTMENT OF INTERIOR
BUREAU OF LAND MANAGEMENT
GEOGRAPHIC REPORT WITH LAND
Sorted by Serial Number

RUN DATE: 06/11/2018

Page 1 of 1

Adm State: AZ

Serial Number: AZA 013138PT

Total Case Acres: 24,649.070

<u>Casetype</u>	<u>Case Disp</u>	14	0200N	0150W	<u>Sect</u>	<u>Sur Typ</u>	<u>Sur Num</u>	<u>Suff</u>	<u>Subdivision</u>	<u>Act Pend</u>
220100	AUTHORIZED				011	ALIQ			N2NW,SESW;	

Serial Number: AZA 022698PT

Total Case Acres: 11,747.600

<u>Casetype</u>	<u>Case Disp</u>	14	0200N	0150W	<u>Sect</u>	<u>Sur Typ</u>	<u>Sur Num</u>	<u>Suff</u>	<u>Subdivision</u>	<u>Act Pend</u>
221006	AUTHORIZED				012	ALIQ ALIQ		1	N2,SW,N2SE,SWSE,N2SESE; SWSESE;	

Serial Number: AZA 029135

Total Case Acres: 22.560

<u>Casetype</u>	<u>Case Disp</u>	14	0200N	0150W	<u>Sect</u>	<u>Sur Typ</u>	<u>Sur Num</u>	<u>Suff</u>	<u>Subdivision</u>	<u>Act Pend</u>
281001	AUTHORIZED				012	MNR		1	E2E2NE;	

Land Patent Details						
Accession Nr: 1114322		Document Type: Serial Patent		State: Arizona	Issue Date: 7/24/1942	Cancelled: No
Names On Document			Miscellaneous Information			
<input checked="" type="checkbox"/> STATE OF ARIZONA Military Rank: ---			Land Office:	Phoenix		
			US Reservations:	Yes		
			Mineral Reservations:	Yes		
			Tribe:	---		
			Militia:	---		
			State In Favor Of:	---		
			Authority:	June 28, 1934: Exchange-State Taylor Act (48 Stat. 1269)		
Document Numbers			Survey Information			
Document Nr:	076192		Total Acres:	1708.66		
Misc. Doc. Nr:	---		Survey Date:	---		
BLM Serial Nr:	AZPHX 0076192		Geographic Name:	---		
Indian Allot. Nr:	---		Metes/Bounds:	No		
Land Descriptions						
State	Meridian	Twp - Rng	Aliquots	Section	Survey #	County
AZ	Gila-Salt River	020N - 015W		12		Mohave
REMARKS: ALL MINERALS RESERVED TO US						
AZ	Gila-Salt River	010N - 006W	W½SW¼	13		Yavapai
REMARKS: ALL MINERALS RESERVED TO US						
AZ	Gila-Salt River	010N - 006W	Lot/Trct 1	14		Yavapai
REMARKS: LOT 1 OF NWNW QUARTER ALL MINERALS RESERVED TO US						
AZ	Gila-Salt River	010N - 006W	Lot/Trct 2	14		Yavapai
REMARKS: LOT 2 OF WEST HALF OF NW QUARTER ALL MINERALS RESERVED TO US						
AZ	Gila-Salt River	010N - 006W	Lot/Trct 3	14		Yavapai
REMARKS: LOT 3 OF NESE QUARTER ALL MINERALS RESERVED TO US						
AZ	Gila-Salt River	010N - 006W	Lot/Trct 4	14		Yavapai
REMARKS: LOT 4 OF NWSE QUARTER ALL MINERALS RESERVED TO US						
AZ	Gila-Salt River	010N - 006W	Lot/Trct 5	14		Yavapai
REMARKS: LOT 5 OF NESW QUARTER ALL MINERALS RESERVED TO US						
AZ	Gila-Salt River	010N - 006W	Lot/Trct 6	14		Yavapai
REMARKS: LOT 6 OF NWSW QUARTER ALL MINERALS RESERVED TO US						
AZ	Gila-Salt River	010N - 006W	Lot/Trct 7	14		Yavapai
REMARKS: LOT 7 OF SWSW QUARTER ALL MINERALS RESERVED TO US						
AZ	Gila-Salt River	010N - 006W	Lot/Trct 8	14		Yavapai
REMARKS: LOT 8 OF SWSW QUARTER ALL MINERALS RESERVED TO US						
AZ	Gila-Salt River	010N - 006W	Lot/Trct 9	14		Yavapai
REMARKS: LOT 9 OF SOUTH HALF OF SW QUARTER ALL MINERALS RESERVED TO US						
AZ	Gila-Salt River	010N - 006W	Lot/Trct 10	14		Yavapai
REMARKS: LOT 10 OF NWSE QUARTER ALL MINERALS RESERVED TO US						
AZ	Gila-Salt River	010N - 006W	Lot/Trct 11	14		Yavapai
REMARKS: LOT 11 OF SOUTH HALF OF SE QUARTER ALL MINERALS RESERVED TO US						
AZ	Gila-Salt River	010N - 006W	W½NE¼	14		Yavapai
REMARKS: ALL MINERALS RESERVED TO US						
AZ	Gila-Salt River	010N - 006W	SE¼NE¼	14		Yavapai
REMARKS: ALL MINERALS RESERVED TO US						
AZ	Gila-Salt River	010N - 006W	E½NW¼	14		Yavapai
REMARKS: ALL MINERALS RESERVED TO US						
AZ	Gila-Salt River	010N - 006W	E½	26		Yavapai
REMARKS: ALL MINERALS RESERVED TO US						
AZ	Gila-Salt River	010N - 006W	N½NW¼	26		Yavapai
REMARKS: ALL MINERALS RESERVED TO US						
AZ	Gila-Salt River	010N - 006W	SE¼NW¼	26		Yavapai
REMARKS: ALL MINERALS RESERVED TO US						
AZ	Gila-Salt River	010N - 006W	NE¼SW¼	26		Yavapai
REMARKS: ALL MINERALS RESERVED TO US						

TOWNSHIP 20 NORTH RANGE 15 WEST OF THE GILA & SALT RIVER MERIDIAN, ARIZONA

SECS	SUBDIVISION																Acres	Kind of Entry or Purpose	Serial Number or Order Number	Action Date	Remarks			
	NE 1/4				NW 1/4				SW 1/4				SE 1/4									Lots	Other Description	
	NE	NW	SW	SE	NE	NW	SW	SE	NE	NW	SW	SE	NE	NW	SW	SE								
For orders affecting disposal or use of unidentified lands withdrawn for classification, minerals, water, and/or other public purposes, and Indian treaties, refer to Index to Miscellaneous Documents																								
9																		LOTS 1128A, 1128B (MS);	58.51	PATENT / ME	27101	6/9/1896	MC 275;	
																		ALL SECS 2, 16, 32, 36;		STATE GRANT	ACT OF CONGRESS	6/20/1910	TITLE TO STATE TO FIX ON APPROVAL OF SURVEY; SUBJECT TO PRIOR RIGHTS;	
12																		ALL	640.00	SRHE	PHX-048286	1/6/1922	CANC 8/23/1927; ✓	
6			X	X					X	X			X	X	X	X	1-7		607.35	PATENT / SRHE	852773	3/2/1922		
3					X	X	X	X	X	X	X	X							316.72					
7																		ALL;	615.16					
17																		ALL;	640.00					
19																		ALL;	615.56					
21																		ALL;	640.00					
29																		ALL;	640.00					
31																		ALL;	616.24					
35																		ALL;	640.00	PATENT / RRG	896546	2/19/1923	17N 14W; WD TO US: 6/14/1967;	
5						X	X	X	X	X	X	X					1, 3, 4		355.33	PATENT / RRG	945412	9/30/1924	18N 10W;	
32	X	X	X	X	X	X	X	X	X	X	X	X							480.00					
36	X	X	X	X	X	X	X	X	X	X	X	X	X	X				PART SWSE;	560.16	IL BASE	82	2/28/1925	12S 25E;	
3			X	X													1, 2		156.24					
23					X	X			X	X	X								200.00					
27	X	X				X	X	X		X	X	X	X	X	X	X			400.00					
33					X	X	X	X	X	X	X	X	X	X					400.00	PATENT / RRG	959097	5/8/1925	15N 1E;	
20																		ALL;	640.00	EO TEMP WDL FOR CL	4230	5/25/1925	WITHDRAWN PENDING LEGISLATION; REV EO 4751, 10/31/1927;	
2			X	X		X	X	X	X	X	X	X					1, 2, 3, PART 4		468.96					
32										X	X	X	X						160.00					
36																		PART SWSE;	5.42	IL BASE	84	8/27/1925	11N 3E;	
																		ALL SECS 2, 16, 32, 36;		STATE GRANT	ACT OF CONGRESS	1/25/1927	EXTENDS ACT OF 6/20/1910 TO MINERAL LANDS; SUBJECT TO PRIOR RIGHTS;	
1																	1	E2SENE, E2NESE;	76.83					
3										X	X	X	X						160.00					
9	X	X		X	X	X			X	X	X	X		X			1		436.44					
11					X	X					X								120.00					

TOWNSHIP 20 NORTH RANGE 15 WEST OF THE GILA & SALT RIVER MERIDIAN, ARIZONA

SECS	SUBDIVISION																Acres	Kind of Entry or Purpose	Serial Number or Order Number	Action Date	Remarks		
	NE 1/4				NW 1/4				SW 1/4				SE 1/4									Lots	Other Description
	NE	NW	SW	SE	NE	NW	SW	SE	NE	NW	SW	SE	NE	NW	SW	SE							
For orders affecting disposal or use of unidentified lands withdrawn for classification, minerals, water, and/or other public purposes, and Indian treaties, refer to Index to Miscellaneous Documents																							
15		X	X		X	X	X	X	X	X	X	X	X	X	X	X		440.00	PATENT / RRG	995000	1/27/1927	12N 14W;	
20																		640.00	EO REV TEMP WDL FOR CL, EO 4230, 5/25/1925	4751	10/31/1927		
20																		640.00	SO WDL RECREATIONAL	7	10/31/1927	WITHDRAWN FROM ALL FORMS OF APPROPRIATION UNDER THE PUBLIC LAND LAWS; REF PATENT 1178252, 1/2/1958;	
30			X										X					80.00	HE	PHX-062373	2/2/1928	PART REL; CANC 7/24/1933;	
28		X	X		X	X	X	X										240.00	PATENT / HE	1012760	2/24/1928		
36															X			66.58	PART SWSE; IL BASE	96	8/25/1928	18N 9W;	
36																		20.661	MS 4070; PATENT / ME	1035726	3/25/1930	20N 14W;	
30													X	X					38N 5W; SO INTPR PW RESERVE 107	131	6/5/1930	REV PLO 2720, 7/9/1962;	
20																		640.00	LEASE / RECREATION	PHX-061981	6/1/1934	CANC 12/6/1939;	
36																		3.43	PART SWSE; IL BASE	130	1/16/1935	10S 18E;	
13	X	X	X	X	X	X	X	X										320.00	PATENT / SRHE	1085581	8/28/1936		
																		8.24	DEFICIENCY;				
2																	PART 4	2.80	IL BASE	179	8/29/1938	4S 29E;	
28	X			X					X	X	X	X	X	X	X	X							
30	X	X	X	X	X				X	X			X	X	X	X	1-4	1015.84	PATENT / ACT OF CONGRESS	1104903	9/13/1939	PART REVERTED TO US: 7/24/1984; NOE;	
12																		640.00	PATENT / SX	1114322	7/24/1942	MIN'S RESERVED TO THE US. <i>6/24/88</i>	
1		X																	RI JOHN ODLE WELL	17	1/12/1943		
34					X	X	X	X											RI MUD SPRING	40	3/15/1943		
26									X	X	X	X							RI DEMOCRAT SPRING	60	3/18/1943		
22				X															RI GRAPEVINE SPRING	39	3/26/1943		
36																		4.41	PART SWSE; IL BASE	216	4/24/1943	23S 14E;	
14					X														RI JOHN ODLE SPRING #3	63	10/1/1943		
32																			S2SWNWSWNW;				
32																		2.50	N2NWSWSWNW; SLUP	AR-0647	1/3/1951	REL 11/21/1951;	
33				X	X	X	X	X	X	X	X	X	X	X				400.00	WD TO US / PX	AR-02021	12/11/1951	O OPENING TO ENTRY 9/15/1981;	
20																		5.00	N2NENESW; SLUP	AR-05540	1/8/1954	REL 10/4/1954;	
4			X																RI CHARIOT SPRING	317	2/2/1954		
4												X							RI BURN SPRING	317	2/2/1954		

TOWNSHIP 20 NORTH RANGE 15 WEST OF THE GILA & SALT RIVER MERIDIAN, ARIZONA

SECS	SUBDIVISION																Acres	Kind of Entry or Purpose	Serial Number or Order Number	Action Date	Remarks		
	NE 1/4				NW 1/4				SW 1/4				SE 1/4									Lots	Other Description
	NE	NW	SW	SE	NE	NW	SW	SE	NE	NW	SW	SE	NE	NW	SW	SE							
For orders affecting disposal or use of unidentified lands withdrawn for classification, minerals, water, and/or other public purposes, and Indian treaties, refer to Index to Miscellaneous Documents																							
8	X	X	X	X														RI SPRINGS AND CORRAL	317	2/2/1954			
32									X									RI WILD COW SPRING	317	2/2/1954			
20										X	X						1.00	RAW MICROWAVE RADIO RELAY SITE	AR-06464	7/20/1954	PROOF OF CONSTRUCTION 3/15/1956; TO TERM 7/19/2004; CASE CLOSED 9/2/2009;		
32							X											RAW TELEVISION RECEIVING STATION	AR-07145	12/9/1954	REL 8/5/1957;		
32							X											RAW TELEVISION RELAY STATION	AR-07145	12/9/1954	REL 10/30/1957;		
18			X		X	X	X						X	X	X	X							
20					X	X			X	X							20N 16W;	RAW TELEPHONE AND TELEGRAPH LINE	AR-09399	8/18/1955	PROOF OF CONSTRUCTION 3/7/1956; REL 3/20/1972;		
20	X	X		X	X	X	X		X	X	X	X	X	X	X	X	1-4	620.01 PATENT / ACT OF CONGRESS	1178252	1/2/1958	NOT OPEN TO ME;		
30													X	X			8N 1E;	PLO REV INTPR PW RESERVE 107, SO INTPR 131, 6/5/1930	2720	7/9/1962	OPEN TO ENTRY 1/7/1963;		
18	X	X	X	X	X				X	X			X	X	X	X	1-4						
32																		ALL;					
33																		1895.40 O CL / R&PP BLM MOTION	AR-033498	4/13/1964	EXPIRED;		
25	X	X	X	X									X	X	X	X		320.00 PATENT / PX	02-65-0079	2/5/1965			
32									X	X			X	X									
33									X	X			X	X			19N 15W;	RAW WILD COW SPRING SANITATION AND PROTECTION PROJECT	AR-035635	1/6/1966	PERPETUAL; 44 LD 513; AMENDED 2/9/1966;		
3					X				X	X							4	WD RECON / PX	AR-036033	6/14/1967	BASE ACCEPTED 9/6/1967; O OPENING TO ENTRY 2/15/1982;		
ENTIRE TOWNSHIP																14N 10W;	O PROPOSED CL FOR MULTIPLE USE MANAGEMENT	A-1359	11/2/1967	SEGREGATES THE PUBLIC LANDS FROM APPROPRIATION UNDER AGRICULTURAL LAND LAWS, PS, SX; PUB IN FR 11/9/1967; O CL 1/16/1968; PUB IN FR 1/23/1968; CL TERM 10/7/1981;			
14									X									RAW RAINWATER CATCHMENT	A-4355	9/22/1969	LD TP: 17N 15W; CANC;		
18				X		X				X	X	X	X	X	X	X	1	20N 16E;	RAW TELEPHONE AND TELEGRAPH LINE	A-1627	1/1/1973	PERPETUAL;	
18																	1	W2SWNE, SESWNE, W2NENW, SENENW, E2SENW, SWNESE, N2NWSE, SENWSE, N2SESE, SESESE;	RAW ELECTRIC DISTRIBUTION LINE	A-10757	12/8/1978	TO TERM 12/7/1998; RENEWED 11/19/2003; TO TERM 11/18/2023;	
8		X																					
9			X															NWSESE, SWSESE;					
10									X									WDL PUBLIC WATER RESERVE 107	A-17601	1/28/1980	19N 15W;		

TOWNSHIP 20 NORTH RANGE 15 WEST OF THE GILA & SALT RIVER MERIDIAN, ARIZONA

SECS	SUBDIVISION																Acres	Kind of Entry or Purpose	Serial Number or Order Number	Action Date	Remarks		
	NE 1/4				NW 1/4				SW 1/4				SE 1/4									Lots	Other Description
	NE	NW	SW	SE	NE	NW	SW	SE	NE	NW	SW	SE	NE	NW	SW	SE							
For orders affecting disposal or use of unidentified lands withdrawn for classification, minerals, water, and/or other public purposes, and Indian treaties, refer to Index to Miscellaneous Documents																							
4			X	X			X	X	X	X	X	X	X	X	X	X	1-4						
14																		ALL;					
36																		ALL LESS MS 4070;	1906.00	LEASE / OG	A-14357	5/14/1981	EFF 6/1/1981; REL 12/30/1983; OG SIM AUG 1984; 20N 14W; CASE CLOSED 11/1/1984;
8																		ALL;					
13																		ALL;					
22																		ALL;					
34																		ALL;	2560.00	LEASE / OG	A-13797	5/29/1981	EFF 6/1/1981; PART ASSIGNED 3/1/1982; TERM 6/1/1985; OG SIM DEC 1985; CASE CLOSED 3/3/1986;
10																		ALL;					
12																		ALL;					
24																		ALL;					
26																		ALL;	2560.00	LEASE / OG	A-13798	5/29/1981	EFF 6/1/1981; PART ASSIGNED 3/1/1982; TERM 6/1/1985; OG SIM DEC 1985; CASE CLOSED 3/3/1986;
33					X	X	X	X	X	X	X	X	X	X						O OPENING TO ENTRY	AR-02021	9/15/1981	
3							X		X	X							4			O OPENING TO ENTRY	AR-036033	2/15/1982	
8					X	X	X	X					X	X	X	X							
13					X	X	X	X					X	X	X	X							
22					X	X	X	X					X	X	X	X							
34					X	X	X	X					X	X	X	X			1280.00	LEASE / OG	A-13797-A	5/7/1982	EFF 4/1/1981; TERM 6/1/1985; OG SIM DEC 1985; CASE CLOSED 3/3/1986;
10					X	X	X	X					X	X	X	X							
12					X	X	X	X					X	X	X	X							
24					X	X	X	X					X	X	X	X							
26					X	X	X	X					X	X	X	X			1280.00	LEASE / OG	A-13798-A	5/7/1982	EFF 4/1/1981; TERM 6/1/1985; OG SIM DEC 1985; CASE CLOSED 3/3/1986;
6		X	X						X	X			X	X	X	X	1-7	21N 16W;	607.35	LEASE / OG	A-18662	9/27/1983	EFF 10/1/1983; TERM 10/1/1985; OG SIM APR 1986; CASE CLOSED 6/1/1986;
25					X	X	X	X	X	X	X	X							320.00	LEASE / OG	A-18665	9/28/1983	EFF 10/1/1983; TERM 10/1/1985; OG SIM APR 1986; OTHER TPS: 19N 15W, 20N 14W; CASE CLOSED 6/1/1986;
1			X										X			X							
24																X				R/W BURIED TELEPHONE CABLE	A-18820	11/30/1983	TO TERM 11/29/2013;
30																		NWNWNE, SENWSWSE, S2NESWSE, SESWSE;	32.50	QCD TO US	PHX-077416	4/6/1984	OPEN TO SURFACE ENTRY 5/8/1985; NOT OPEN TO THE MINING OR MINERAL LEASING LAWS;

TOWNSHIP 20 NORTH RANGE 15 WEST OF THE GILA & SALT RIVER MERIDIAN, ARIZONA

SECS	SUBDIVISION																Acres	Kind of Entry or Purpose	Serial Number or Order Number	Action Date	Remarks		
	NE 1/4				NW 1/4				SW 1/4				SE 1/4									Lots	Other Description
	NE	NW	SW	SE	NE	NW	SW	SE	NE	NW	SW	SE	NE	NW	SW	SE							
For orders affecting disposal or use of unidentified lands withdrawn for classification, minerals, water, and/or other public purposes, and Indian treaties, refer to Index to Miscellaneous Documents																							
3							X			X	X						4						
4		X	X			X	X	X	X	X	X	X	X	X	X	X	1-4						
5		X	X										X	X	X	X	2						
8																		ALL;					
9																	2-6						
18	X	X	X	X					X	X			X	X	X	X	1-4	2471.34	NORA / PX	A-19151	5/24/1984	SEGREGATED FROM THE PUBLIC LAND LAWS AND THE MINING LAWS BUT NOT THE MINERAL LEASING LAWS; SEG TO TERM 5/23/1986; WDI AND CASE CLOSED 7/15/1985;	
30																		32.50	QCD TO US	PHX-077416	7/27/1984	R&PP REVERSION TITLE ACCEPTED 8/24/1984; RECON TO US: 8/24/1984;	
30																		32.50	OPENING ORDER	PHX-077416	5/8/1985	OPEN TO SURFACE ENTRY;	
30																			RAW COMMUNICATION SITE	A-20920	11/26/1985	PERPETUAL;	
30																			RAW COMMUNICATION SITE	A-21085	11/26/1985	CANC AND CASE CLOSED 3/4/1989;	
30																			RAW COMMUNICATION SITE	A-20667	12/30/1985	TO TERM 12/29/2015;	
30																			RAW COMMUNICATION SITE	A-20308	1/6/1986	TO TERM 1/5/2016;	
30																			RAW COMMUNICATION SITE	A-21093	1/6/1986	TO TERM 10/2/2016;	
32					X	X	X	X											RAW COMMUNICATION SITE	A-19138	2/20/1986	TO TERM 2/21/1991; CASE CLOSED 9/1/1993;	
30																			RAW COMMUNICATION SITE	A-20921	3/14/1986	TO TERM 9/23/2018;	
30																			RAW COMMUNICATION SITE	A-21381	3/14/1986	TO TERM 3/13/2006; RENEWED 10/10/2006; TO TERM 10/9/2026;	
30																			RAW COMMUNICATION SITE	A-21414	4/1/1986	TO TERM 3/31/2016; AMENDED 3/28/2011; TO TERM 12/31/2030;	
30																			RAW COMMUNICATION SITE	A-21788	7/29/1986	TO TERM 7/29/2006; AMENDED 3/10/1998; TO TERM 3/9/2018;	
17													X	X	X	X	0.60		RAW COMMUNICATION SITE	A-23398	8/1/1986	TO TERM 7/31/1996; TERM AND CASE CLOSED 7/31/1993; REF AZA-27359, 4/20/1993;	
30															X		2.50		RAW COMMUNICATION SITE	A-19158	11/13/1986	TO TERM 11/12/1996; RENEWED 10/21/1996, 6/17/1997, 9/30/1997, 1/1/1998; TO TERM 11/1/2018;	
25					X	X	X	X	X	X	X	X							NORA / PX	A-13138	12/12/1986	SEGREGATES THE LANDS FROM ALL APPROPRIATIONS UNDER THE PUBLIC LAND LAWS, INCLUDING THE MINING LAWS, BUT NOT THE MINERAL LEASING LAWS; SEG TO TERM 12/11/1988; LD TP: 20N 14W;	
25					X	X	X	X											RAW ROAD	A-22805	6/10/1987	PERPETUAL;	
18		X		X			X						X	X	X	X	1						

TOWNSHIP 20 NORTH RANGE 15 WEST OF THE GILA & SALT RIVER MERIDIAN, ARIZONA

SECS	SUBDIVISION																Acres	Kind of Entry or Purpose	Serial Number or Order Number	Action Date	Remarks			
	NE 1/4				NW 1/4				SW 1/4				SE 1/4									Lots	Other Description	
	NE	NW	SW	SE	NE	NW	SW	SE	NE	NW	SW	SE	NE	NW	SW	SE								
For orders affecting disposal or use of unidentifed lands withdrawn for classification, minerals, water, and/or other public purposes, and Indian treaties, refer to Index to Miscellaneous Documents																								
20																		5	MS 4515;		RAW ROAD	A-22645	7/1/1987	PERPETUAL;
17																X			0.254	RAW COMMUNICATION SITE	A-23401	7/1/1987	TO TERM 12/8/1994; CASE CLOSED 12/9/1994;	
1																	1	E2SENE, E2NESE;						
3			X	X					X	X				X	X	X	1-3							
11					X	X							X											
13	X	X	X	X	X	X	X	X																
15		X	X		X	X	X	X	X	X	X	X		X										
23					X	X				X	X	X												
25																		M&B;						
27		X	X					X	X	X				X	X	X								
35																		ALL;		WD TO US / PX	A-13138	7/28/1987	LD TP: 19N 14W;	
25					X	X	X	X	X	X	X	X								PATENT / PX	02-87-0041	8/28/1987	(A-13138); OTHER TPS: 20N 14W, 20N 21W;	
2													X	X	X	X								
12	X	X	X	X	X	X	X	X	X	X	X	X	X	X	X			N2SESE, SWSESE;		WD TO US	A-22698	8/31/1987	LD TP: 19N 14W;	
2													X	X	X	X								
12	X	X	X	X	X	X	X	X	X	X	X	X				X		N2SESE, SWSESE;		OPENING ORDER	A-22698	10/1/1987	AT 9:00 AM ON 11/2/1987 THE LAND ACQUIRED BY THE US WILL OPEN TO THE OPERATION OF THE PUBLIC LAND LAWS, THE GENERAL MINING LAWS AND THE MINERAL LEASING LAWS; ★	
30																		NWNWNE;		RAW COMMUNICATION SITE	A-22955	10/7/1987	TO TERM 11/6/2007; RENEWED 3/25/2008; TO TERM 12/31/2028;	
1																	1	E2SENE, E2NESE;						
3			X	X					X	X				X	X	X	1-3							
11					X	X							X											
13	X	X	X	X	X	X	X	X										PARCEL 2;						
15		X	X						X	X	X	X	X	X	X	X								
23						X	X					X	X											
25																		M&B;		OPENING ORDER / PX	A-13138	12/10/1987	AT 9:00 AM ON 1/11/1988 THE LAND WILL BE OPEN TO THE OPERATION OF THE PUBLIC LAND LAWS;	
15		X	X		X	X	X	X	X	X	X	X		X						OPENING ORDER / CORRECTION	A-13138	1/20/1988		
23					X	X				X	X	X												
30																		SENWSWSE, E2SWSWSE, S2NESWSE, SESWSE;		RAW COMMUNICATION SITE	A-22683	6/1/1988	TO TERM 5/31/2008; AMENDED 3/2/1989; RENEWED 7/29/2010; TO TERM 12/31/2028;	

TOWNSHIP 20 NORTH RANGE 15 WEST OF THE GILA & SALT RIVER MERIDIAN, ARIZONA

SECS	SUBDIVISION																Acres	Kind of Entry or Purpose	Serial Number or Order Number	Action Date	Remarks			
	NE 1/4				NW 1/4				SW 1/4				SE 1/4									Lots	Other Description	
	NE	NW	SW	SE	NE	NW	SW	SE	NE	NW	SW	SE	NE	NW	SW	SE								
For orders affecting disposal or use of unidentified lands withdrawn for classification, minerals, water, and/or other public purposes, and Indian treaties, refer to Index to Miscellaneous Documents																								
19																		S2SWSWSE, SESESESW;		R/W COMMUNICATION SITE	A-23400	6/15/1988	TRFD BY EXCHANGE; TO TERM 5/1/1992; RENEWED 5/1/1992; TO TERM 1/31/1994; CASE CLOSED 2/1/1994;	
17																X				R/W COMMUNICATION SITE	A-23402	6/15/1988	TRFD BY EXCHANGE; TO TERM 2/28/20009; ISSUED 8/19/2012; TO TERM 12/31/2032;	
19																		WEST 440 FT OF S2NWSWSE, S2E2NESESW;		R/W COMMUNICATION SITE	A-23411	6/15/1988	TO TERM 10/14/2008;	
17													X	X	X	X			0.23	R/W COMMUNICATION SITE	A-23412	6/15/1988	REL 7/21/1994; CASE CLOSED 7/22/1994;	
17												X	X	X	X			0.60	R/W COMMUNICATION SITE	A-23398	6/15/1988	EFF 8/1/1986; TERM AND CASE CLOSED 7/31/1993;		
17																		S2NESE, N2SESE;	0.69	R/W COMMUNICATION SITE	A-23413	6/15/1988	TO TERM 3/24/2018;	
17													X						0.15	R/W COMMUNICATION SITE	A-23399	6/15/1988	TO TERM 6/16/1993; CASE CLOSED 9/8/1993;	
5									X	X	X	X	X				1,3							
7	X	X	X	X	X			X	X			X	X	X	X	X	1-4	EXCEPT HUALAPAI MTN RD;						
9	X			X		X	X		X	X	X	X			X	1								
17																		ALL;						
19	X	X	X	X	X			X	X			X	X	X	X	X	1-4	EXCEPT HUALAPAI MTN RD;						
21	X	X	X	X	X	X	X	X	X	X			X	X	X	X		EXCEPT M&B;						
31	X	X	X	X	X			X	X			X	X	X	X	X	1-4			WD RECON TO US	A-22792-A	6/17/1988	OPENING ORDER 3/13/1989; TITLE ACCEPTED 10/31/1989; LD TP: 19N 15W;	
5								X	X	X	X	X					1,3							
7	X	X	X	X	X			X	X			X	X	X	X	X	1-4	EXCEPT HUALAPAI MTN RD;						
9	X			X		X	X		X	X	X	X			X	1								
17																		ALL;						
19	X	X	X	X	X			X	X			X	X	X	X	X	1-4	EXCEPT HUALAPAI MTN RD;						
21	X	X	X	X	X	X	X	X	X	X			X	X	X	X		EXCEPT M&B;						
31	X	X	X	X	X			X	X			X	X	X	X	X	1-4			OPENING ORDER	A-22792-A	3/13/1989	SURFACE ONLY; AT 9:00 AM ON 3/13/1989 THE LAND WILL BE OPEN TO THE PUBLIC LAND LAWS; LD TP: 19N 15W;	
30																		SENWSWSE, E2SWSWSE, S2NESWSE, SESWSE;	0.27	R/W COMMUNICATION SITE	AZA-25585	9/26/1991	PERPETUAL;	
19													X	X					1.40	R/W BURIED TELEPHONE CABLE	AZA-25623	7/23/1992	TO TERM 7/22/2022; AMENDED 3/24/1994;	

TOWNSHIP 20 NORTH RANGE 15 WEST OF THE GILA & SALT RIVER MERIDIAN, ARIZONA

SECS	SUBDIVISION																Acres	Kind of Entry or Purpose	Serial Number or Order Number	Action Date	Remarks		
	NE 1/4				NW 1/4				SW 1/4				SE 1/4									Lots	Other Description
	NE	NW	SW	SE	NE	NW	SW	SE	NE	NW	SW	SE	NE	NW	SW	SE							
For orders affecting disposal or use of unidentified lands withdrawn for classification, minerals, water, and/or other public purposes, and Indian treaties, refer to Index to Miscellaneous Documents																							
33					X	X	X	X										160.00	WD RECON	AZA-26359-A	4/9/1993	MINERAL ESTATE ADMIN BY BLM;	
17																		0.25	RAW COMMUNICATION SITE	AZA-27359	4/20/1993	TO TERM 7/31/2023; EFF 8/1/1993;	
17																		0.15	RAW COMMUNICATION SITE	AZA-28170	3/4/1994	TO TERM 3/3/2024;	
30																		0.23	RAW BURIED TELEPHONE CABLE AMENDED	AZA-25623	3/24/1994	TO TERM 7/22/2022;	
19																		1.10	PART S2SWSWSE, SESESESW;	AZA-28338	11/16/1994	EFF 2/1/1994; TO TERM 1/31/2014; AMENDED 3/24/1998; TO TERM 3/23/2018;	
17																		0.517	RAW COMMUNICATION SITE	AZA-28502	12/8/1994	TO TERM 3/9/2018;	
30																			SESWSE;				
31	X	X	X	X																			
32		X			X	X	X	X										1.21	RAW TELEPHONE COMMUNICATION SITE, ACCESS ROAD AND TRANSMISSION LINE	AZA-28155	1/31/1995	TO TERM 1/30/1999; RENEWED 3/3/2000; TO TERM 8/30/2002; CASE CLOSED 9/5/2002;	
12																			RAW ACCESS ROAD	AZA-29135	2/15/1996	TO TERM 2/14/2026; LD TP: 20N 14W; AMENDED 11/24/1997;	
1				X												1	10.03	RAW ACCESS ROAD AMENDED	AZA-29135	11/24/1997	PERPETUAL;		
19													X	X									
30																		1.65	RAW COMMUNICATION SITE	AZA-30100	12/1/1997	TO TERM 12/1/2027;	
17															X			1.03	RAW ACCESS ROAD	AZA-30101	7/21/1998	TO TERM 7/20/2028;	
30																		0.10	RAW COMMUNICATION SITE	AZA-30623	10/2/1998	TO TERM 10/1/2018;	
30																		0.001	RAW COMMUNICATION SITE	AZA-25565-B	4/5/2004	PERPETUAL;	
30																		0.001	RAW COMMUNICATION SITE	AZA-25565-A	5/10/2005	PERPETUAL;	
13	X																		LD TP: 20N 14W;	AZA-33143	8/26/2005	TO TERM 8/25/2035;	
21													X	X				4.137	RAW ROAD	AZA-33606	9/21/2006	PERPETUAL;	
30													X					0.01	RAW GENERATOR FACILITY	AZA-35535	2/14/2011	TO TERM 12/31/2030;	
23																		0.002	RAW WEATHER MONITORING STATION	AZA-36372	9/3/2013	TO TERM 12/31/2042;	
4																4		0.002	RAW WEATHER MONITORING STATION	AZA-36373	9/3/2013	TO TERM 12/31/2042;	
17													X	X	X	X		0.08	RAW COMMUNICATION SITE	AZA-35906	9/26/2014	TO TERM 12/31/2034;	
24																			E2E2SESE;				
25																			PART;	AZA-37286	7/10/2017	TO TERM 12/31/2047;	

TOWNSHIP 20 NORTH RANGE 15 WEST OF THE GILA & SALT RIVER MERIDIAN, ARIZONA

SECS	SUBDIVISION						Acres	Kind of Entry or Purpose	Serial Number or Order Number	Action Date	Remarks					
	NE 1/4	NW 1/4	SW 1/4	SE 1/4	Lots	Other Description										
	NE	NW	SW	SE	NE	NW	SW	SE	NE	NW	SW	SE	For orders affecting disposal or use of unidentified lands withdrawn for classification, minerals, water, and/or other public purposes, and Indian treaties, refer to Index to Miscellaneous Documents			

May 25, 2018

US Department of the Interior
Bureau of Land Management
1 North Central Avenue
Suite 800
Phoenix, AZ 85004

Dear Sir/Madam

Please see enclosed the documentation, including maps, for six, (6), lode mining claims located on March 25 2018 and filed and recorded by Mohave County on April 19, 2018 for Pershing Resources Company. All six EN lode mining claims were located, dated and, posted by Nick Barr, acting as agent for Pershing Resources Company.

Also enclosed is a return envelope and a cashier's check to the US Department of the Interior for **\$1272.00** to cover the filing and initial maintenance fees for the six lode mining claims at \$212.00 per claim filed/recorded.

The six, (6), EN Lode Mining Claims for BLM recordation are;

EN#139

EN#141

EN#143

EN#145

EN#147

EN#149

Please contact me directly if there is any information that is missing or that requires further explanation. Thank you for your attention to this matter.

Kind regards,

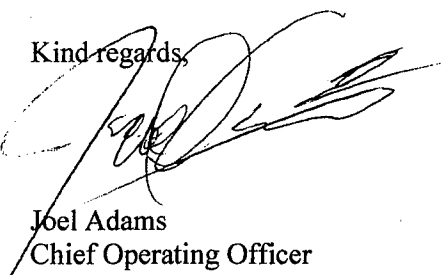
Joel Adams
Chief Operating Officer
Director and Corporate Secretary
Pershing Resources Company
200 South Virginia Street 8th Floor
Reno, Nevada 89501
jadams@pershingpm.com
646 387 6859 (cell)

RECEIVED
BLM
PHOENIX, ARIZONA

2018 MAY 31 P 2:29

AMC451026

Extremely Urgent

This envelope is for use with the following services: **UPS Next Day Air®**
UPS Worldwide Express™
UPS 2nd Day Air®

Visit theupsstore.com or call **1-800-PICK-UPS®** (1-800-742-5877) to find a location near you.

Domestic Shipments

- To qualify for the Letter rate, UPS Express Envelopes may only contain correspondence, urgent documents, and/or electronic media, and must weigh 8 oz. or less. UPS Express Envelopes containing items other than those listed or weighing more than 8 oz. will be billed by weight.

International Shipments

- The UPS Express Envelope may be used only for documents of no commercial value. Certain countries consider electronic media as documents. Visit ups.com/importexport to verify if your shipment is classified as a document.
- To qualify for the Letter rate, the UPS Express Envelope must weigh 8 oz. or less. UPS Express Envelopes weighing more than 8 oz. will be billed by weight.

Note: Express Envelopes are not recommended for shipments of electronic media containing sensitive personal information or breakable items. Do not send cash or cash equivalent.

Apply shipping documents on this side.

Do not use this envelope for:

- UPS Ground**
- UPS Standard**
- UPS 3 Day Select®**
- UPS Worldwide Expedited®**

Visit theupsstore.com to learn more about our Print & Business Services.

JOEL ADAMS
(646) 387-6859
THE UPS STORE #6514
163 AMSTERDAM AVE
NEW YORK NY 10023-5001

0.2 LBS LTR 1 C
SHP WT: LTR
DATE: 29 MAY 2018

SHIP ATTN BUREAU OF LAND MANAGMENT
TO: US DEPARTMENT OF THE INTERIOR
STE 800
1 N CENTRAL AVE

PHOENIX AZ 85004-4427



UPS 2ND DAY AIR A.M. 2A
TRACKING #: 1Z 0V0 937 19 5134 9629

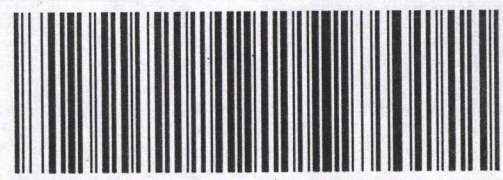

BILLING: P/P
SIGNATURE REQUIRED

REF #1: NJ

ISH 13.00N Z2P 450 99.5U 04/2018

SEE NOTICE ON REVERSE regarding UPS Terms, and notice of limitation of liability. Where allowed by law, shipper authorizes UPS to act as forwarding agent for export control and customs purposes. If exported from the US, shipper certifies that the commodities, technology or software were exported from the US in accordance with the Export Administration Regulations. Diversion contrary to law is prohibited. RSD 8 0518

PHOENIX, ARIZONA
2018 MAY 31 P 2:29
RECEIVED
SHIP AND DATE OFFICE

than 100 years
United Parcel Service.



International Shipping Notice — Carriage hereunder may be subject to the rules relating to liability and other terms and/or conditions established by the Convention for the Unification of Certain Rules Relating to International Carriage by Air (the "Warsaw Convention") and/or the Convention on the Contract for the International Carriage of Goods by Road (the "CMR Convention"). These commodities, technology or software were exported from the U.S. in accordance with the Export Administration Regulations. Diversion contrary to U.S. law prohibited.

01880250709 07/15 United Parcel Service

100% Recycled fiber
80% Post-Consumer

The UPS Store®



Print & Business Services

Express envelope

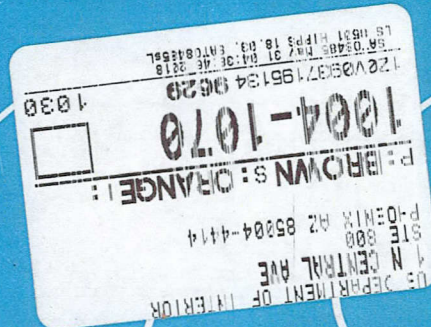

theupsstore.com

theupsstorefranchise.com